



Subway

OHSU School of Nursing, Ashland...

Southern Oregon University

Southern Grounds Coffee Shop

113

Schneider Museum of Art

Suzanne Holmes Hall

Deboer Sculpture Room

Omar's Fresh Seafood & Steaks

Marion Ady Building
Replace (4) SinglePly Roofs

Art Building
Replace (4) SinglePly Roofs

ITB 2026-05 ATTACHMENT B
Art & Marion Ady Roof Replacement
Vicinity Map

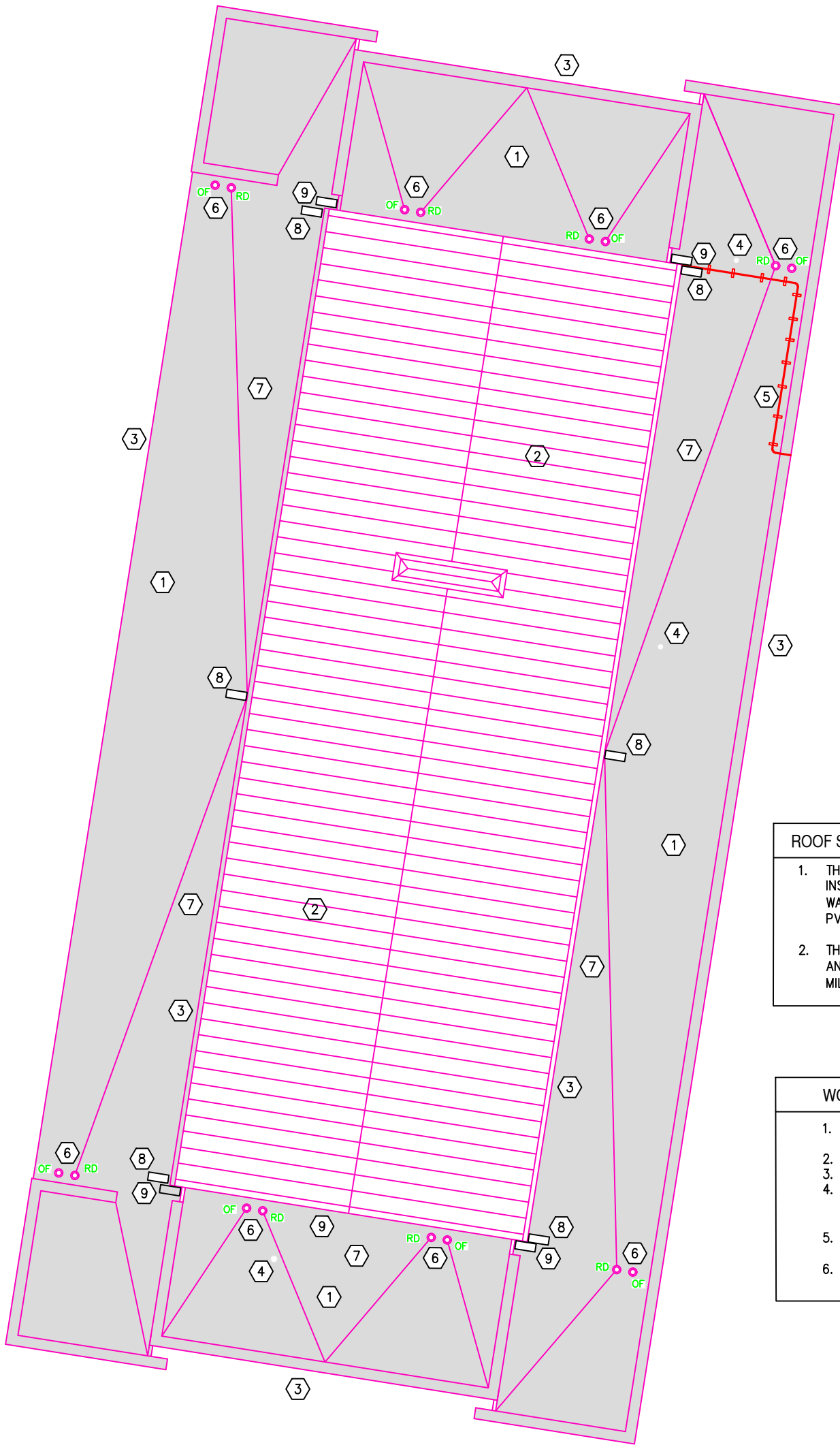

KEYED NOTES	
①	AREA-OF-WORK SHOWN SHADED. REMOVE AND DISPOSE OF EXISTING MEMBRANE AND COVER BOARD. INSTALL NEW DENSDECK UNDERLAYMENT AND 60 MIL PVC MEMBRANE, MECHANICALLY FASTENED.
②	EXISTING METAL ROOF. NO WORK.
③	CAREFULLY REMOVE & REUSE ALL METAL FLASHINGS AND COPINGS. AT CONTRACTOR'S OPTION, NEW 24-GAUGE PREFINISHED (KYNAR) PARAPET COPINGS CAN BE INSTALLED.
④	EXISTING PLUMBING VENT. FIELD VERIFY SIZES.
⑤	EXISTING SOLAR CONDUIT ON RUBBER BLOCKS. PROTECT IN PLACE.
⑥	REUSE EXISTING ROOF AND OVERFLOW DRAINS AND DRAIN GUARDS. PROVIDE NEW CLAMP RINGS AND ACCESSORIES AS REQUIRED BY MEMBRANE MANUFACTURER.
⑦	INSTALL NEW GUARDIAN CB-12 FALL PROTECTION ANCHORS AT FIVE (5) LOCATIONS. ATTACH EACH CB-12 DIRECTLY TO METAL DECK WITH FORTY (40) #14 X 3" LONG DECK SCREWS. INFILL AROUND ANCHORS WITH RIGID INSULATION. VERIFY ANCHOR LOCATIONS WITH SOU PRIOR TO INSTALLATION.
⑧	INSTALL (10) NEW RECYCLED RUBBER SPLASH BLOCKS WHERE SHOWN. ("GROUND SMART" SPLASH BLOCK BY LIBERTY TIRE RECYCLING OR APPROVED EQUAL).
⑨	WALKPADS: INSTALL 2.5 FT. X 4 FT. PADS WHERE SHOWN.

ROOF SYSTEM DESCRIPTION	
1.	THE ORIGINAL ROOF SECTION IS A EPDM MEMBRANE OVER TAPERED INSULATION OVER METAL DECK, ALL FULLY ADHERED. IN 2011 THE ROOF WAS OVERLAID WITH 1/4" DENSDECK (MECHANICALLY FASTENED) AND A PVC MEMBRANE (FULLY ADHERED).
2.	THIS PROJECT WILL REMOVE THE 2011 DENSDECK AND PVC MEMBRANE AND INSTALL NEW DENSDECK (MECHANICALLY FASTENED) AND A NEW 60 MIL PVC MEMBRANE (MECHANICALLY FASTENED).

WORK SCOPE	
1.	REMOVE AND DISPOSE OF THE EXISTING PVC MEMBRANE AND COVER BOARD.
2.	INSTALL NEW DENSDECK COVER BOARD, MECHANICALLY FASTENED.
3.	INSTALL A NEW 60 MIL PVC MEMBRANE, MECHANICALLY FASTENED.
4.	REMOVE AND RE-INSTALL EXISTING FLASHINGS & COPINGS, OR, AT CONTRACTOR'S OPTION, INSTALL NEW PRE-FINISHED FLASHINGS AND PARAPET CAPS..
5.	PROVIDE A 20-YEAR NDL MANUFACTURER'S WARRANTY. THE WARRANTY SCOPE EXTENDS TO THE OUTSIDE FACE-OF-WALL.
6.	REFER TO THE SPECIFICATIONS IN THE PROJECT MANUAL FOR DETAILED REQUIREMENTS.

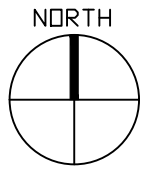

SOU ITB 2026-05 ATTACHMENT B
 ART BUILDING - ROOF PLAN
 Scale: 1/16" = 1'-0" (11x17P)

KEYED NOTES

- ① AREA-OF-WORK SHOWN SHADED. REMOVE AND DISPOSE OF EXISTING MEMBRANE AND COVER BOARD. INSTALL NEW DENSDECK UNDERLAYMENT AND 60 MIL PVC MEMBRANE, MECHANICALLY FASTENED.
- ② EXISTING METAL ROOF. NO WORK.
- ③ CAREFULLY REMOVE & REUSE METAL FLASHINGS AND COPINGS. AT CONTRACTOR'S OPTION, NEW 24-GAUGE PREFINISHED (KYNAR) METAL COPINGS CAN BE INSTALLED.
- ④ EXISTING PLUMBING VENT. FIELD VERIFY SIZES.
- ⑤ EXISTING SOLAR CONDUIT ON RUBBER BLOCKS. PROTECT IN PLACE.
- ⑥ REUSE EXISTING ROOF AND OVERFLOW DRAINS AND DRAIN GUARDS. PROVIDE NEW CLAMP RINGS AND ACCESSORIES AS REQUIRED BY MEMBRANE MANUFACTURER.
- ⑦ INSTALL NEW GUARDIAN CB-12 FALL PROTECTION ANCHORS AT (5) LOCATIONS. ATTACH EACH CB-12 DIRECTLY TO METAL DECK WITH FORTY (40) #14 X 3" LONG DECK SCREWS. INFILL AROUND ANCHORS WITH RIGID INSULATION. VERIFY ANCHOR LOCATIONS WITH SOU PRIOR TO INSTALLATION.
- ⑧ INSTALL (6) NEW RECYCLED RUBBER SPLASH BLOCKS AT DOWNSPOUTS. ("GROUND SMART" SPLASH BLOCK BY LIBERTY TIRE RECYCLING OR APPROVED EQUAL)
- ⑨ WALKPADS: INSTALL WHERE SHOWN. PROVIDE 2.5 FT. X 4 FT. PADS AT ROOF ENTRIES.
- ⑩ GENERATOR EXHAUST. INSTALL NEW FLASHINGS AT EXHAUST PIPE THIMBLE.

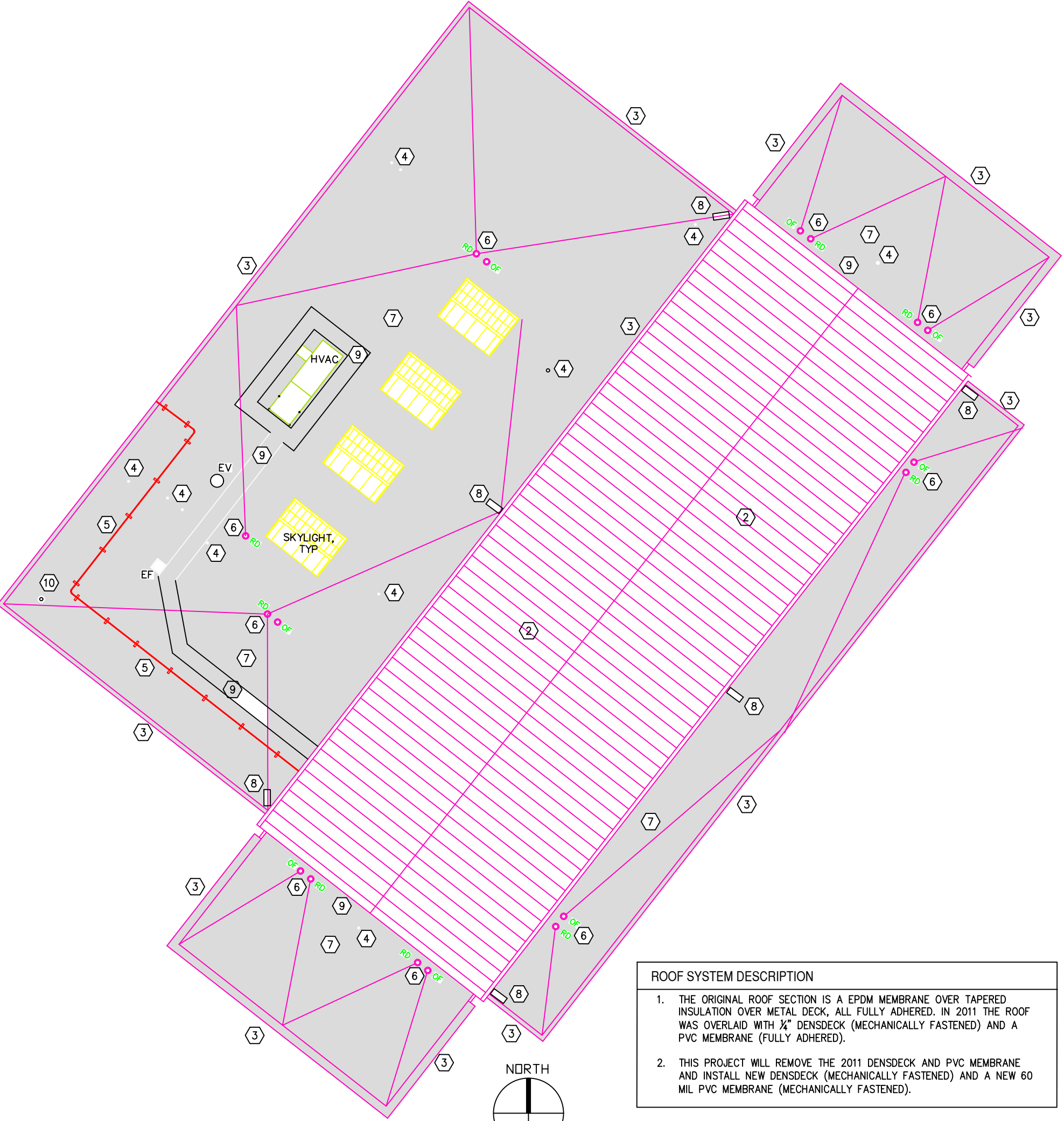

ROOF SYSTEM DESCRIPTION

- 1. THE ORIGINAL ROOF SECTION IS A EPDM MEMBRANE OVER TAPERED INSULATION OVER METAL DECK, ALL FULLY ADHERED. IN 2011 THE ROOF WAS OVERLAID WITH 1/4" DENSDECK (MECHANICALLY FASTENED) AND A PVC MEMBRANE (FULLY ADHERED).
- 2. THIS PROJECT WILL REMOVE THE 2011 DENSDECK AND PVC MEMBRANE AND INSTALL NEW DENSDECK (MECHANICALLY FASTENED) AND A NEW 60 MIL PVC MEMBRANE (MECHANICALLY FASTENED).

WORK SCOPE

- 1. REMOVE AND DISPOSE OF THE EXISTING PVC MEMBRANE AND COVER BOARD.
- 2. INSTALL NEW DENSDECK COVER BOARD, MECHANICALLY FASTENED.
- 3. INSTALL A NEW 60 MIL PVC MEMBRANE, MECHANICALLY FASTENED.
- 4. REMOVE AND RE-INSTALL EXISTING FLASHINGS & COPINGS, OR, AT CONTRACTOR'S OPTION, INSTALL NEW PRE-FINISHED FLASHINGS AND PARAPET CAPS..
- 5. PROVIDE A 20-YEAR NDL MANUFACTURER'S WARRANTY. THE WARRANTY SCOPE EXTENDS TO THE OUTSIDE FACE-OF-WALL.
- 6. REFER TO THE SPECIFICATIONS IN THE PROJECT MANUAL FOR DETAILED REQUIREMENTS.

SOU ITB 2026-05 ATTACHMENT B
 MARION ADY BUILDING - ROOF PLAN
 Scale: 1/16" = 1'-0" (11x17P)