REQUEST FOR INVITATION TO BID #2026-02
CAMPUS ELECTRICAL DISTRIBUTION
ADDENDUM III
March 4, 2026

On February 10, 2026, the Oregon Institute of Technology (“Oregon Tech”) published Invitation to Bid #2026-02 for Campus Electrical Distribution; as amended by Addendum I to the Invitation to Bid #2026-02 for Campus Electrical Distribution, dated February 16, 2026; and Addendum II to the Invitation to Bid #2026-02 for Campus Electrical Distribution, dated March 2, 2026 (collectively, “BID”).

Oregon Tech has found that it is in its interest to amend the BID through the issuance of this Addendum III. Except as expressly amended below, all other terms and conditions of the original BID shall remain unchanged.

1. **Exhibit A – Plans (v.02162026)** shall be amended to include the attached Revised C1.1 – C1.4.

End of Addendum III



LEGEND	
	SEWER SERVICE
	STORM DRAIN LINES
	GAS SERVICE
	POWER SERVICE
	WATER SERVICE

GENERAL NOTES

1. VERIFY EXISTING UTILITY LOCATIONS PRIOR TO ANY UNDERGROUND WORK OR EXCAVATION
2. ALL EXISTING CONDUIT THAT IS TO BE REPLACED IS TO BE REMOVED - VERIFY WITH OWNER AND ENGINEER PRIOR TO REMOVAL
3. ENGINEER WILL PROVIDE CONCRETE AND COMPACTION TESTING - CONTRACTOR TO SUPPLY EARTH & AGGREGATE SAMPLES.
4. SUBMIT ALL PRODUCT DATA TO ENGINEER FOR APPROVAL. ELECTRONIC SUBMITTALS ARE ACCEPTABLE.

CONCRETE NOTES

- 1) MIX DESIGN:
MINIMUM 6 SACK MIX
STRENGTH: 4000 PSI @ 28 DAYS
SLUMP: 4" ± 1"
AIR ENT.: 5% ± 1%
SUBMIT MIX DESIGN TO ENGINEER FOR APPROVAL
 - 2) CONCRETE SHALL NOT BE POURED ON FROZEN GROUND. CONCRETE PLACED DURING COLD WEATHER SHALL BE BLANKETED FOR A MINIMUM OF 24 HOURS. COLD WEATHER IS DESCRIBED AS, FOR 3 CONSECUTIVE DAYS, THE AVERAGE DAILY TEMPERATURE IS LESS THAN 40 DEGREES AND THE AIR TEMPERATURE IS LESS THAN 50 DEGREES.
 - 3) CONSOLIDATE CONCRETE BY MEANS OF A HIGH-FREQUENCY, INTERNAL, MECHANICAL VIBRATOR SUPPLEMENTED BY HAND SPADING.
- CONCRETE FORM WORK**
- 1) CONSTRUCT FORM WORK IN ACCORDANCE WITH ACI 301 AND 347.
 - 2) VERTICAL FACE, EXPOSED CONCRETE:
MINIMUM 3/4" PLYWOOD WITH "B" GRADE FACE TO CONCRETE. EARTH FORMS SHALL NOT BE PERMITTED.
 - 3) VERIFY LINES AND GRADES PRIOR TO PLACING CONCRETE.
 - 4) ARRANGE AND ASSEMBLE FORM WORK TO PERMIT STRIPPING OF FORMS WITHOUT DAMAGING CONCRETE.
 - 5) APPLY FORM RELEASE AGENT IN ACCORDANCE WITH MANUFACTURER'S INSTRUCTIONS. KEEP SURFACES WET JUST PRIOR TO CONCRETE PLACEMENT.
- REINFORCING STEEL**
- 1) REINFORCING BARS SHALL CONFORM TO ASTM A615 GRADE 60.
 - 2) TIE WIRE SHALL BE CLEAN AND FREE OF SCALE OR RUST.
 - 3) PLACE REINFORCEMENT AS SHOWN ON THE DRAWINGS. PROVIDE SUPPORTING DEVICES NECESSARY TO MAINTAIN THE REINFORCEMENT IN-PLACE DURING CONCRETE PLACEMENT AND CONSOLIDATION.
 - 4) COVER REQUIREMENTS:
AGAINST EARTH: 3 INCHES CLEAR
FORMED CONCRETE AGAINST EARTH: 2 INCHES CLEAR
 - 5) ALL STEEL SHALL BE TIED IN-PLACE. NO STABBING OF REINFORCING SHALL BE ALLOWED.

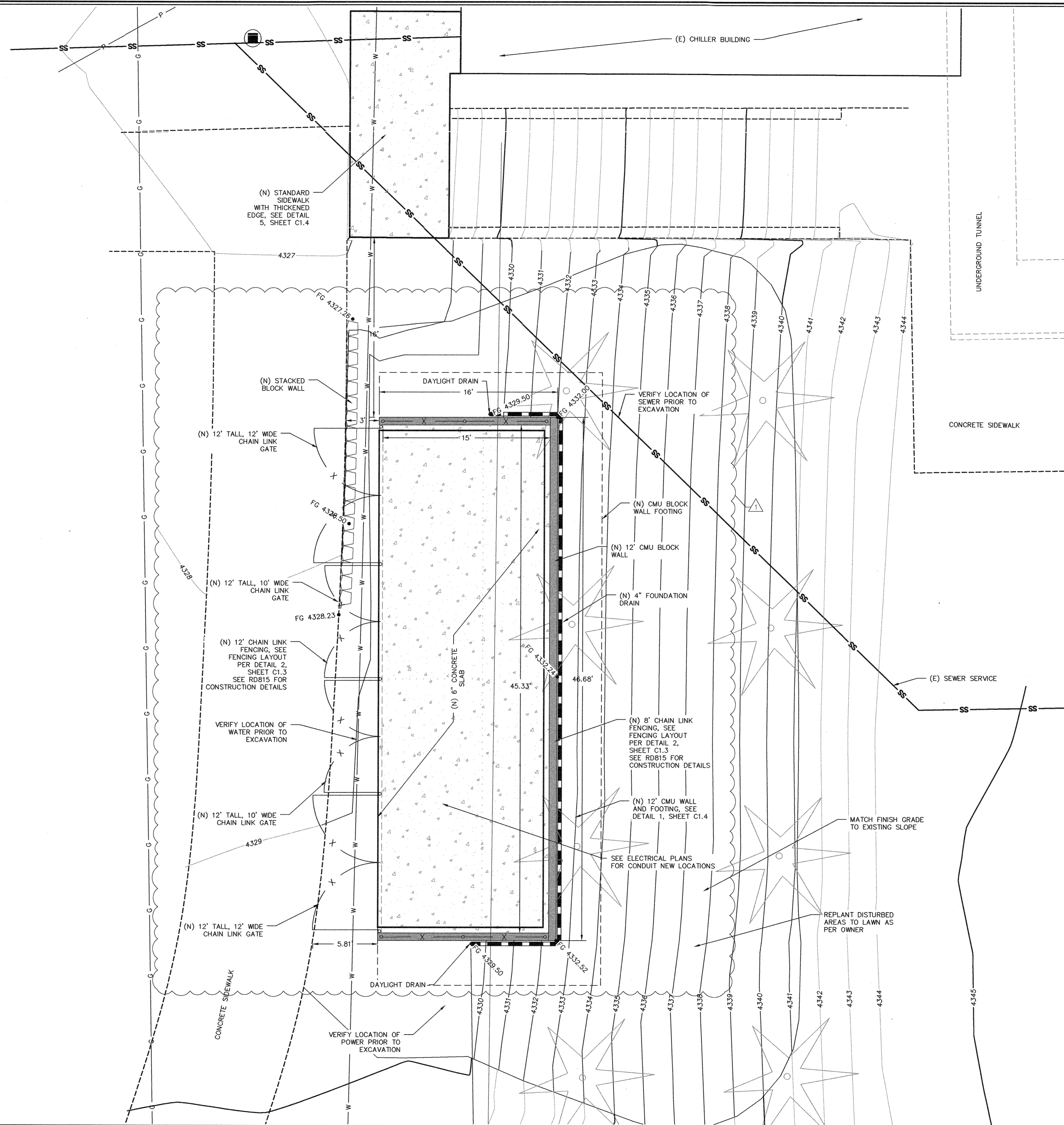

1
C1.1
PROPOSED SITE PLAN
1" = 5'

P.O. BOX 28
LAKEVIEW, OR. 97630
WWW.SHN-ENGR.COM
541-947-4407

FLUENT ENGINEERING
STEWARDSHIP THROUGH DESIGN™
2110 STATE STREET
SALEM, OREGON 97301
503-447-5030
FLUENTENGINEERING.COM
60% SET WHEN UNSIGNED

ALADKINS
ENGINEERING & SURVEYING o / 541.884.4666
w / AdkinsEngineering.com
1435 ESPLANADE AVENUE, KLAMATH FALLS, OR 97601
SERVING S. OREGON & N. CALIFORNIA
ENGINEERING • SURVEYING • PLANNING • TESTING

Brian Brown Engineering
PO Box 563
Fort Klamath, Oregon 97626
541-783-3347

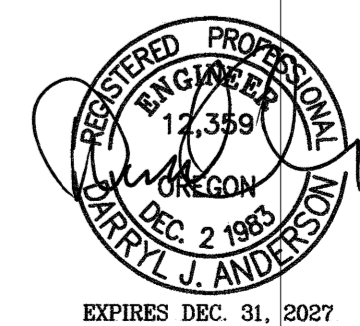

DATE	REVISION DESCRIPTION	BY
9/2/25 <td>NOTES, FIX TEXT <td>R.C.</td> </td>	NOTES, FIX TEXT <td>R.C.</td>	R.C.
3/1/26 <td>LOWER CMU WALL, REMOVE COVER</td> <td>R.C.</td>	LOWER CMU WALL, REMOVE COVER	R.C.

PREPARED FOR:
OREGON TECH
3201 CAMPUS DRIVE
KLAMATH FALLS, OR 97601

ELECTRICAL PAD PROPOSED SITE PLAN
OREGON INSTITUTE OF TECHNOLOGY
3201 CAMPUS DR.,
KLAMATH FALLS, OREGON 97601

DATE:	6/25/2025
SCALE:	1"=5'
DWG. BY:	R.C.
FILE:	225005
JOB NO.:	225005
SHEET	C1.1

CONSTRUCTION SET

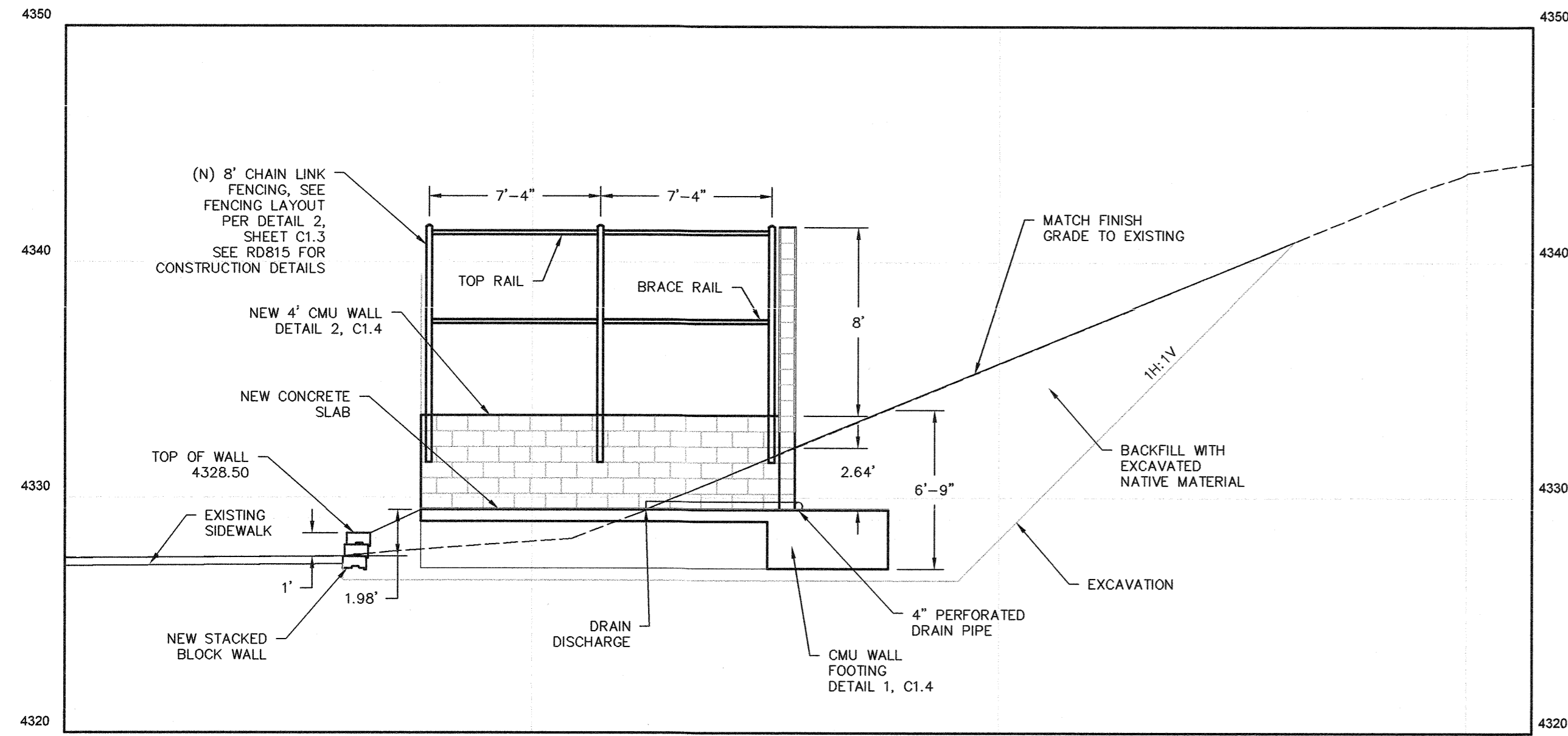

1 NORTH WALL SECTION
C1.2 1" = 5'

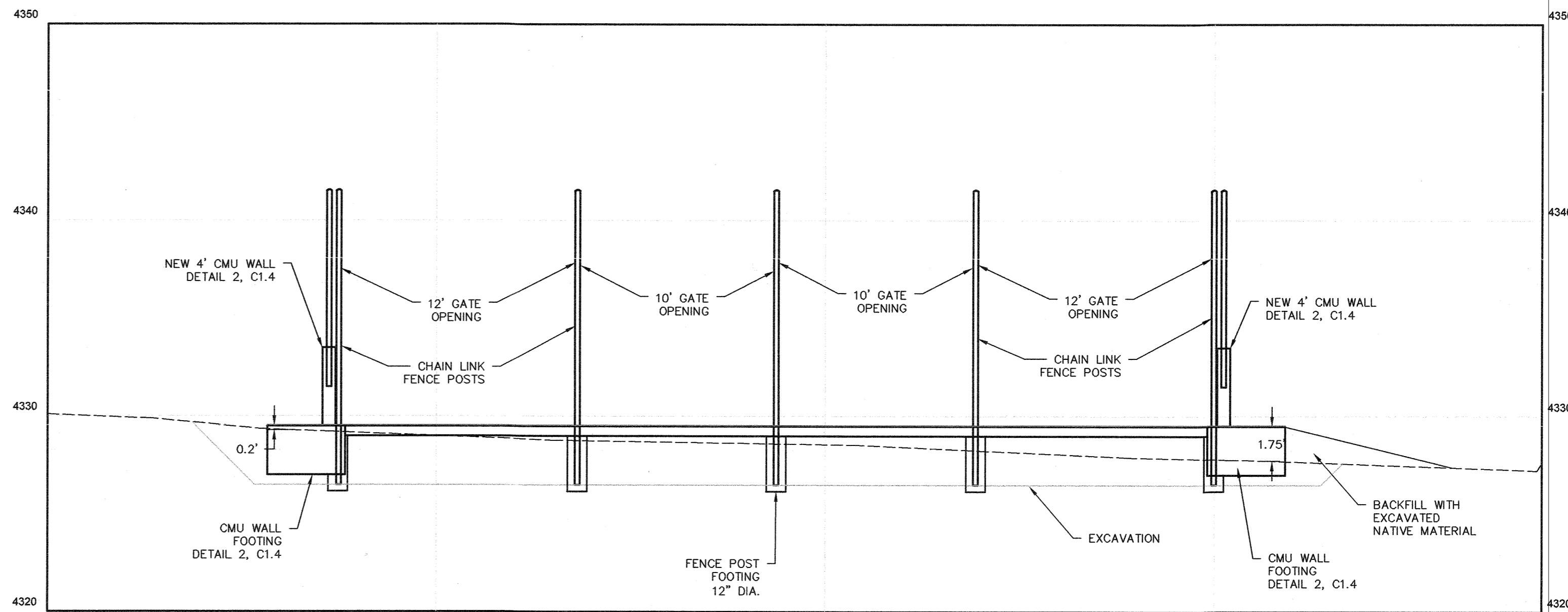

1 WEST WALL SECTION
C1.2 1" = 5'

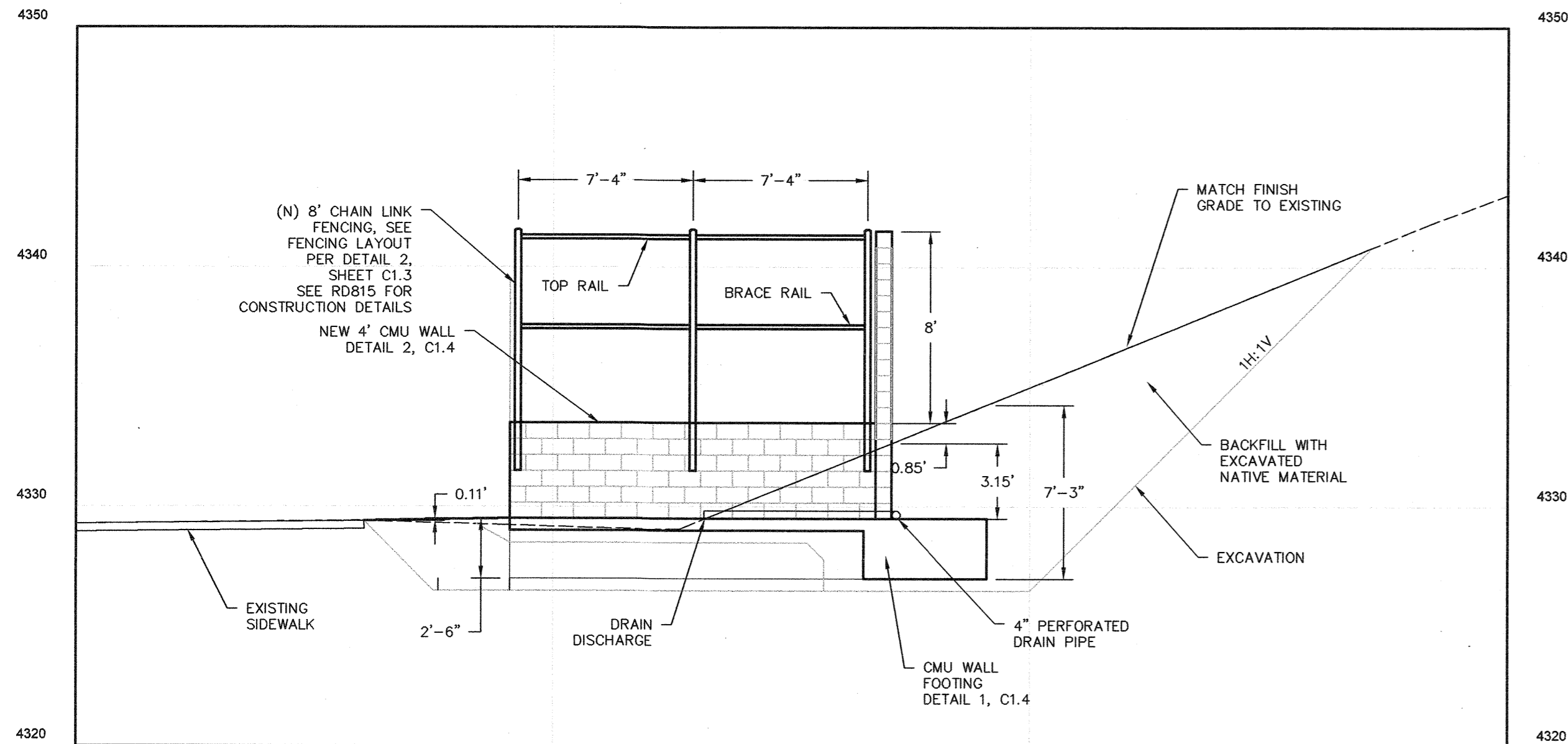

3 SOUTH WALL SECTION
C1.2 1" = 5'

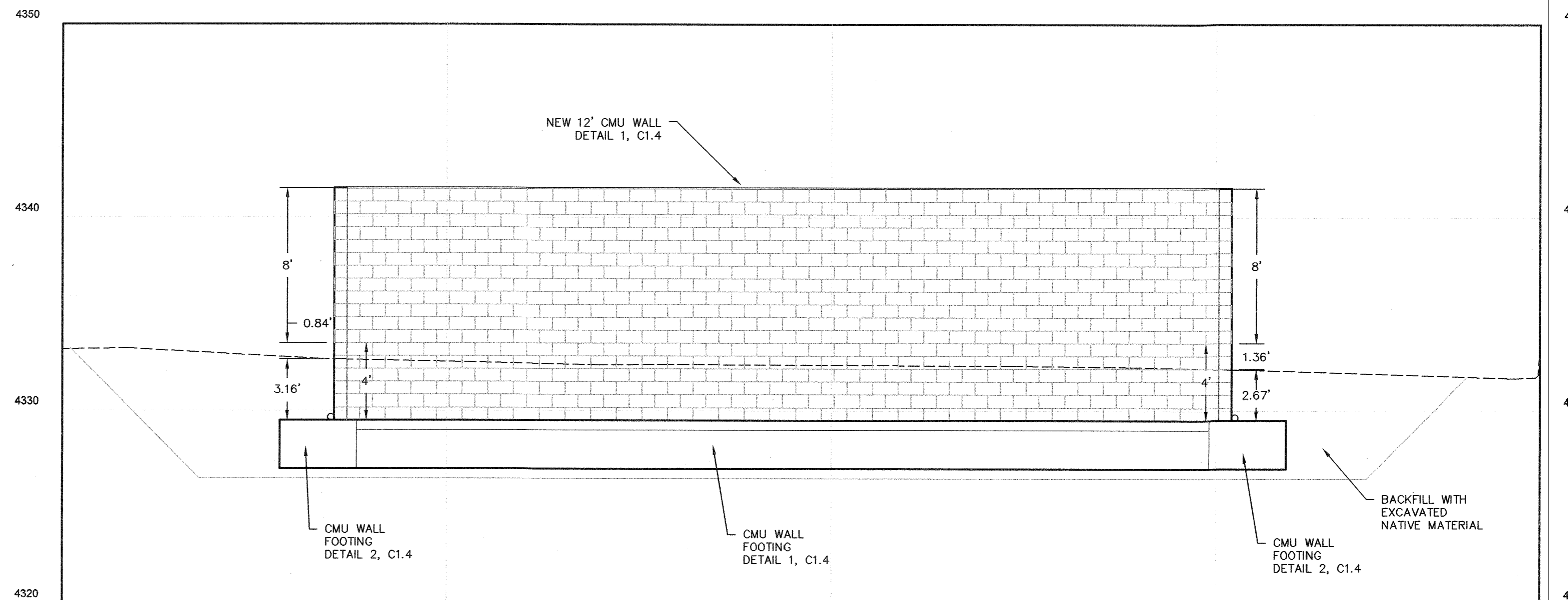

4 EAST WALL SECTION
C1.2 1" = 5'

DATE	REVISION DESCRIPTION	BY
8/2/25	FIX TEXT	R.C.
3/1/26	LOWER CMU WALL, REMOVE COVER	R.C.

PREPARED FOR:
OREGON TECH
3201 CAMPUS DRIVE
KLAMATH FALLS, OR 97601

ELECTRICAL PAD WALL SECTIONS
OREGON INSTITUTE OF TECHNOLOGY
3201 CAMPUS DR,
KLAMATH FALLS, OREGON 97601

DATE:	6/25/2025
SCALE:	1"=5'
DWG. BY:	R.C.
FILE:	225005
JOB NO.:	225005
SHEET	C1.2

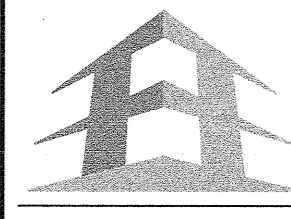

FLUENT
ENGINEERING
STEWARDSHIP THROUGH DESIGN™
2110 STATE STREET
SALEM, OREGON 97301
503-447-5030
FLUENTENGINEERING.COM
50% SET WHEN UNSIGNED

ALADKINS
ENGINEERING & SURVEYING o / 541.884.4666
w / AdkinsEngineering.com
1435 ESPLANADE AVENUE, KLAMATH FALLS, OR 97601
SERVING S. OREGON & N. CALIFORNIA
ENGINEERING • SURVEYING • PLANNING • TESTING

Brian Brown Engineering
PO Box 563
Fort Klamath, Oregon 97626
541-783-3347

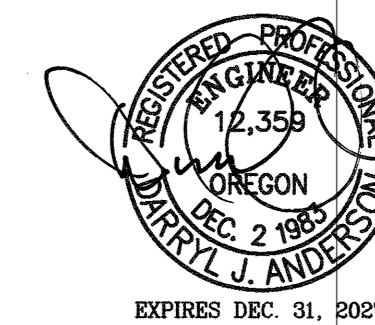

CONSTRUCTION SET

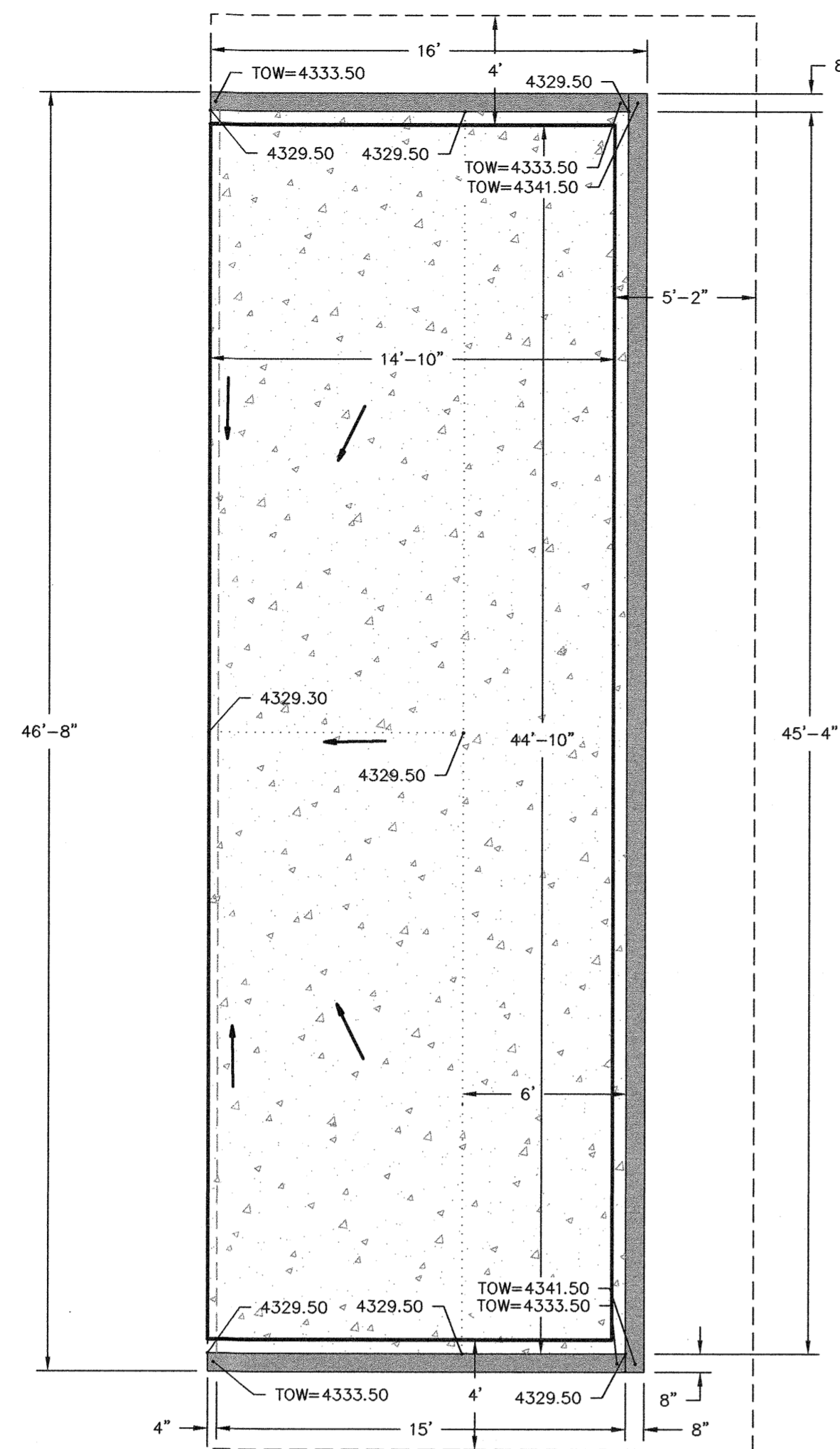

1 CONCRETE PAD PLAN VIEW
C1.3 1" = 5'

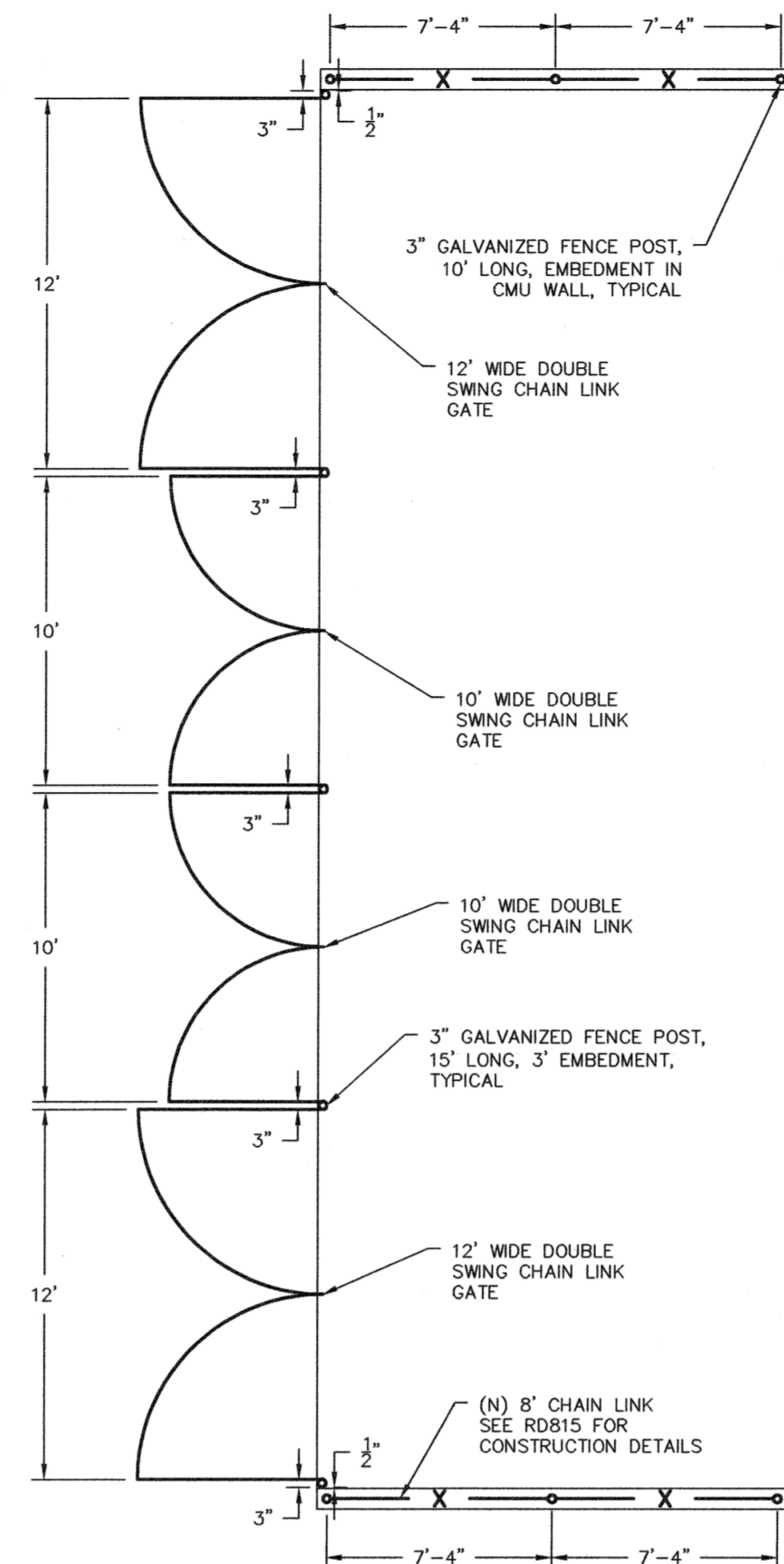

2 CHAIN LINK FENCE PLAN VIEW
C1.3 1" = 5'

3 NOT USED
C1.3 N.T.S.

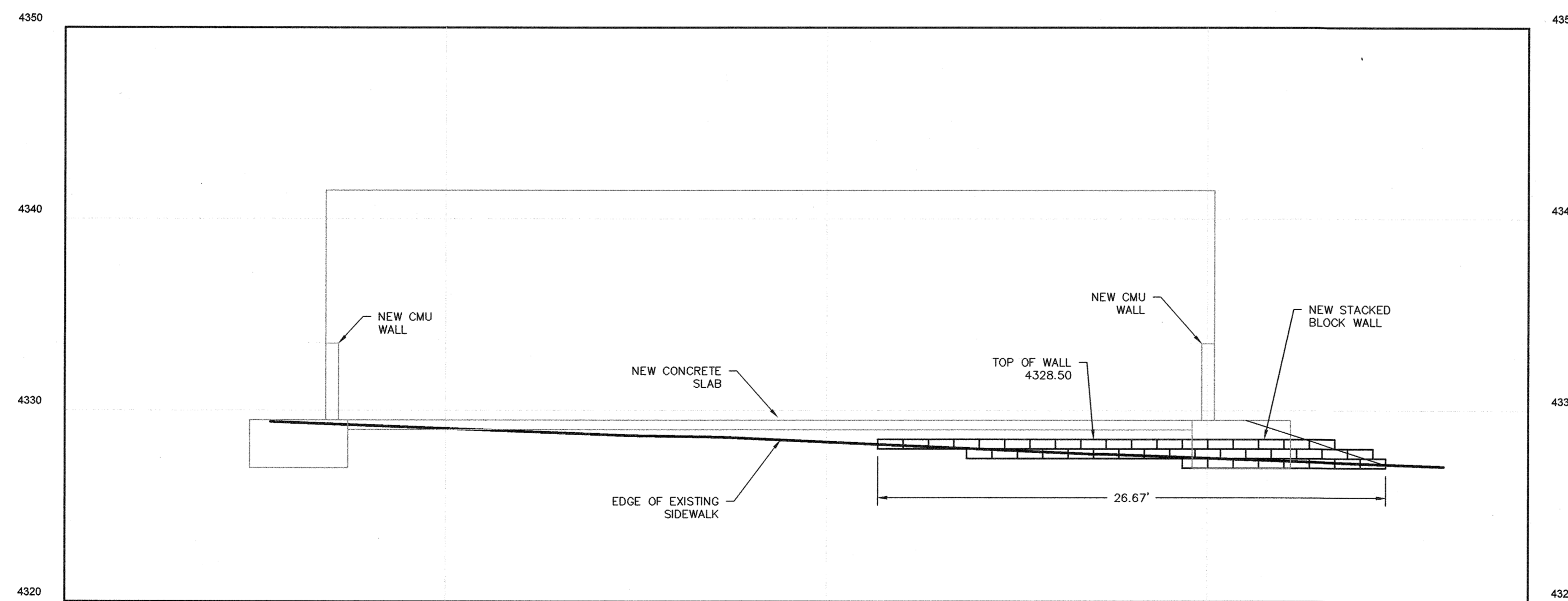

4 BLOCK WALL SECTION
C1.3 1" = 5'



P.O. BOX 28
LAKEVIEW, OR. 97630
WWW.SHN-ENGR.COM
541-947-4407



FLUENT ENGINEERING
STEWARDSHIP THROUGH DESIGN™
2110 STATE STREET
SALEM, OREGON 97301
503-447-5030
FLUENTENGINEERING.COM
50% BET WHEN UNSIGNED

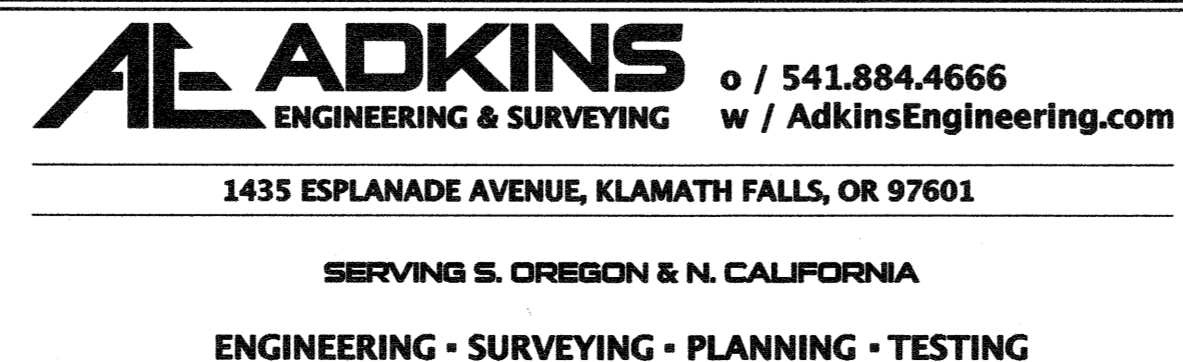

ALADKINS ENGINEERING & SURVEYING o / 541.884.4666
w / AdkinsEngineering.com
1435 ESPLANADE AVENUE, KLAMATH FALLS, OR 97601
SERVING S. OREGON & N. CALIFORNIA
ENGINEERING • SURVEYING • PLANNING • TESTING

Brian Brown Engineering
PO Box 563
Fort Klamath, Oregon 97626
541-783-3347

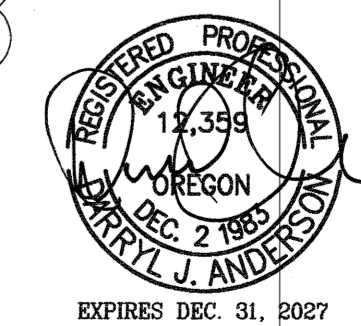

EXPIRES DEC. 31, 2027

DATE	REVISION DESCRIPTION	BY	R.C.
3/7/26	LOWER CMU WALL REMOVE COVER		

PREPARED FOR:
OREGON TECH
3201 CAMPUS DRIVE
KLAMATH FALLS, OR 97601

ELECTRICAL PAD PLAN VIEWS
OREGON INSTITUTE OF TECHNOLOGY
3201 CAMPUS DR,
KLAMATH FALLS, OREGON 97601

DATE:	6/25/2025
SCALE:	1"=5'
DWG. BY:	R.C.
FILE:	225005
JOB NO.:	225005
SHEET	C1.3

CONSTRUCTION SET

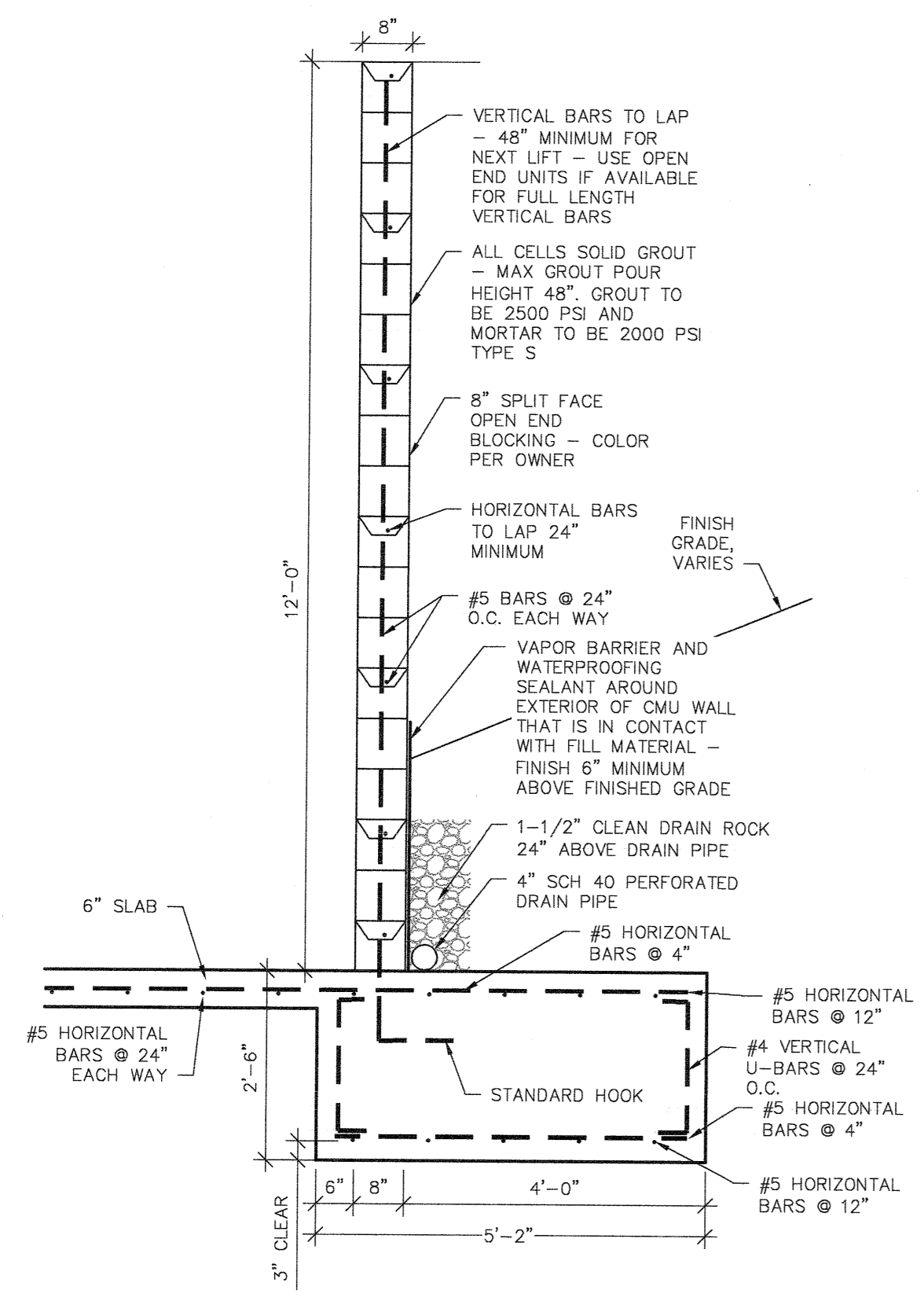

1 BLOCK WALL SECTION
C1.4 1/2" = 1'

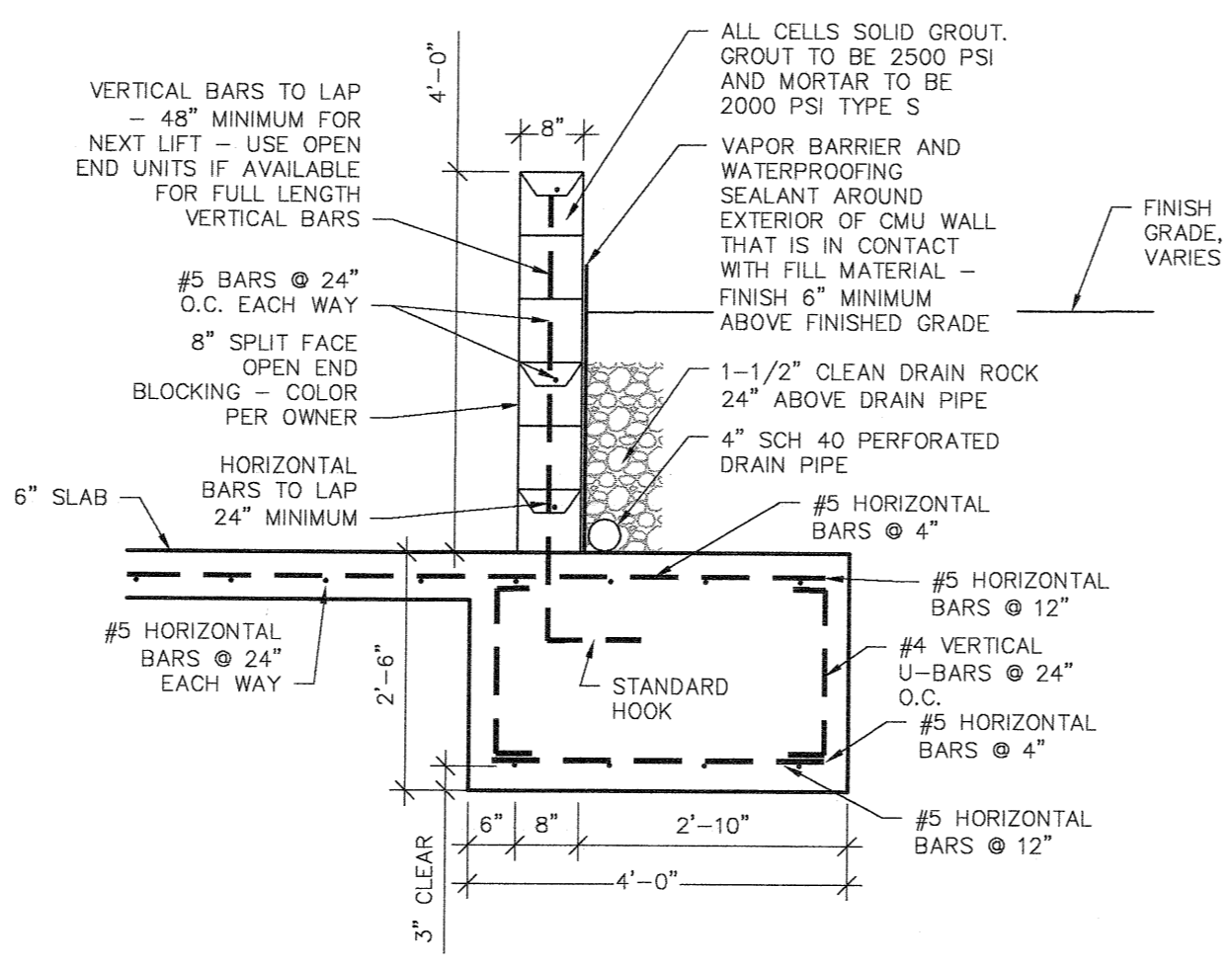

2 BLOCK WALL SECTION
C1.4 1/2" = 1'

3 NOT USED
C1.4 N.T.S.

4 NOT USED
C1.4 N.T.S.

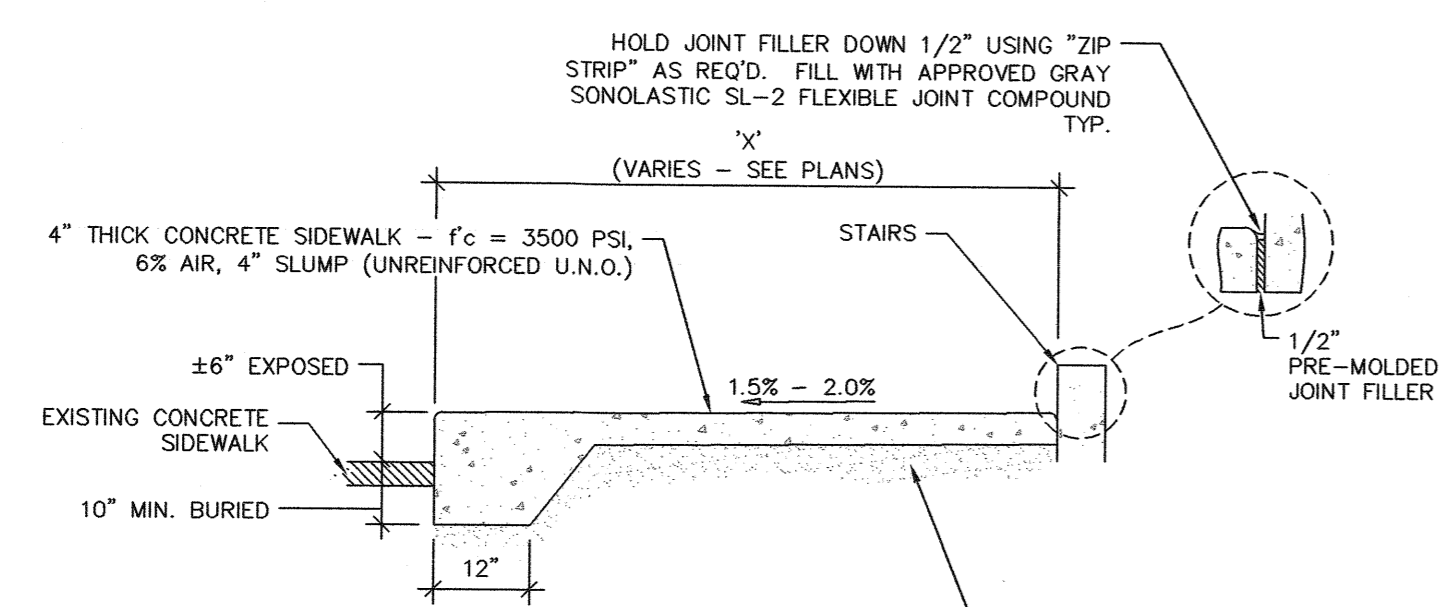

5 THICKENED EDGE SIDEWALK
C1.4 1/2" = 1'

TYPE CL-6
600'-0" max. run
10'-0" max. spacing
For runs of fence of 20' or less, omit truss rod and install lower brace rail in alternate position at End and Corner Posts.

TYPE CL-6R
600'-0" max. run
10'-0" max. spacing
* See general note 8

TYPES CL-4 & CL-5
600'-0" max. run
10'-0" max. spacing
* See general note 8

TYPES CL-4R & CL-5R
600'-0" max. run
10'-0" max. spacing
** End, gate, corner or intermediate end post
* See general note 8

GATES
Gate frame 1 1/2" nom. pipe size
* See general note 8

TYPE	D			F		
	min. (in)	nom. (in)	max. (in)	min. (in)	nom. (in)	max. (in)
CL-4	30	24	48			
CL-5	36	36	60			

TABLE 1 MEMBER

TYPE	BRACE AND TOP RAILS		LINE POSTS		END, CORNER & INTERMEDIATE END POST		GATE OPENING (ft)		GATE POSTS	
	TUBULAR	H-SECTION	TUBULAR	H-SECTION	TUBULAR	H-SECTION	SINGLE GATE	DOUBLE GATE	TUBULAR	H-SECTION
CL-4 & CL-4R	1 1/2"	1 1/2"	1 1/2"	1 1/2"	2 1/2"	2 1/2"	Up thru 6	Up thru 12	2 1/2"	2 1/2"
CL-5 & CL-5R	1 1/2"	1 1/2"	2"	2"	2 1/2"	2 1/2"	7 thru 13	13 thru 26	4"	3 1/2"
CL-6 & CL-6R	1 1/2"	1 1/2"	2 1/2"	2 1/2"	4 1/2"	2 1/2"	14 thru 18	27 thru 36	6"	6"

GENERAL NOTES FOR ALL DETAILS ON THIS SHEET:

- Do not use top rail where fence can be struck by an errant vehicle.
- Fittings shown are illustrative of use and not specific as to design.
- Gate posts on each side of a gate opening to be the same size. At a double gate installation with unequal width gates, size of both posts to be as indicated for a single gate installation of the wider gate width.
- For cross sectional dimensions of members, see Table 1.
- Posts and rails with sections not shown that meet the requirements of AASHTO M181 are acceptable alternatives.
- See ODOT's OPL for acceptable alternatives.
- All concrete shall be commercial grade concrete.
- All chain link fabric top and bottom selvage shall be knuckled finish.
- Chain link fabric for the fence to be installed with pickets shall be 9 gauge wire woven in 3 1/2" by 5 1/2" diamond mesh.
- See project plans for details not shown.
- Add fence grounding as required.

CHAIN LINK FENCE

REGISTRATION NO. 12,359
EXPIRES DEC. 31, 2027

Effective Date: June 1, 2025 - November 30, 2025

DATE	REVISION DESCRIPTION	BY
3/1/26	LOWER CMU WALL - REMOVE COVER	R.C.

PREPARED FOR:
OREGON TECH
3201 CAMPUS DRIVE
KLAMATH FALLS, OR 97601

ELECTRICAL PAD DETAILS
OREGON INSTITUTE OF TECHNOLOGY
3201 CAMPUS DR,
KLAMATH FALLS, OREGON 97601

DATE:	6/25/2025
SCALE:	AS SHOWN
DWG. BY:	R.C.
FILE:	225005
JOB NO.:	225005
SHEET:	C1.4

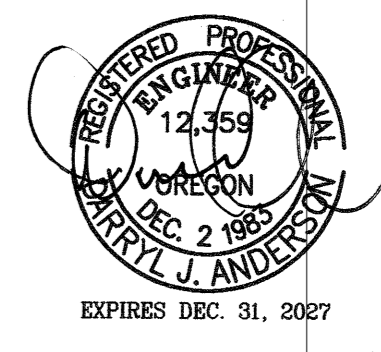
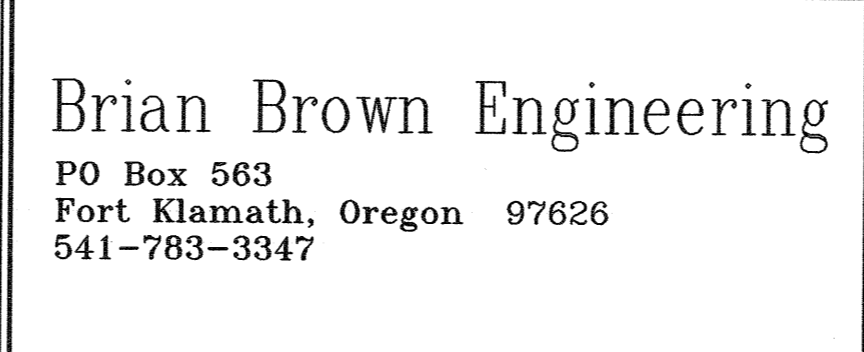
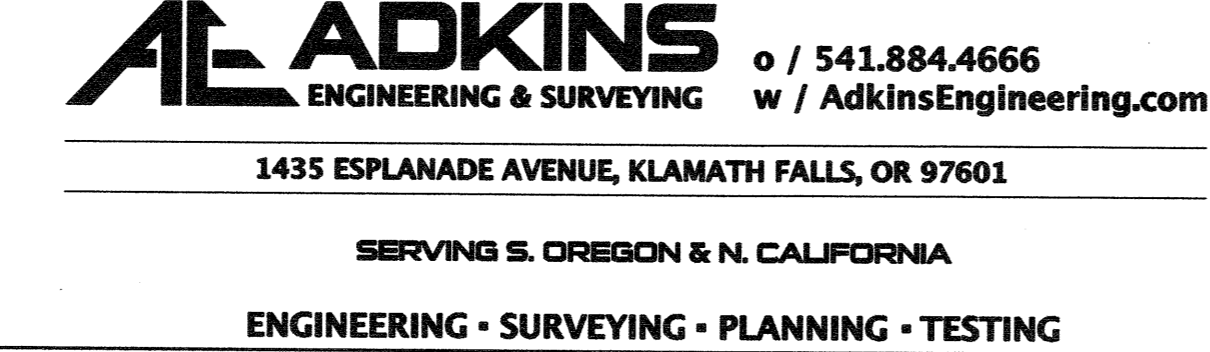
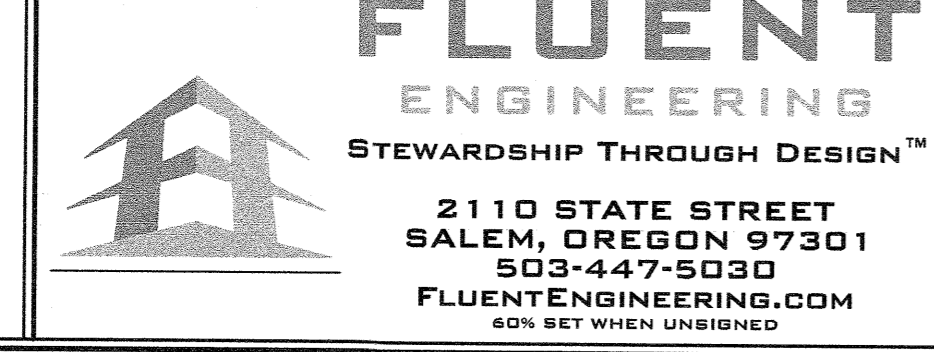

CONSTRUCTION SET